



education

Department:
Education
North West Provincial Government
REPUBLIC OF SOUTH AFRICA

RUSTENBURG LEO

GRADE 10

**MATHEMATICAL LITERACY
TERM 3 TEST
SEPTEMBER 2024**

Stanmorephysics.com

MARKS: 50

TIME: 1 hour

This question paper consists of 8 pages.

INSTRUCTIONS AND INFORMATION

1. This question paper consists of **THREE** questions. Answer **ALL** the questions.
2. Start **EACH** question on a **NEW** page.
3. Number the answers correctly according to the numbering system used in this question paper.
4. You may use an approved calculator (non-programmable and non-graphical), unless stated otherwise.
5. Show **ALL** calculations clearly.
6. Round off **ALL** final answers appropriately according to the given context, unless stated otherwise.
7. Indicate units of measurement, where applicable.
8. Diagrams are **NOT** necessarily drawn to scale, unless stated otherwise.
9. Write neatly and legibly.



QUESTION 1

1.1 Study the table below and write down the letter of the definition which best matches the term.

1.1.1 Interest rate	A. Diagram of a building from a top view usually drawn to scale
1.1.2 Simple Interest	B. A fee that is charged by the lender to the borrower for the right to use the borrowed funds
1.1.3 Stop order	C. The amount earned or charged, expressed as a percentage of money invested or borrowed
1.1.4 Floor plan	D. Interest computed only on the principal amount
	E. An arrangement between the client and the bank to pay a fixed amount of money from his/ her account into another to another account on a specific date every month

(2×4)

1.2 Ms Tau has bought a house. The diagram below shows the layout of the rooms in her house. Study the layout plan and answer the questions that follow.

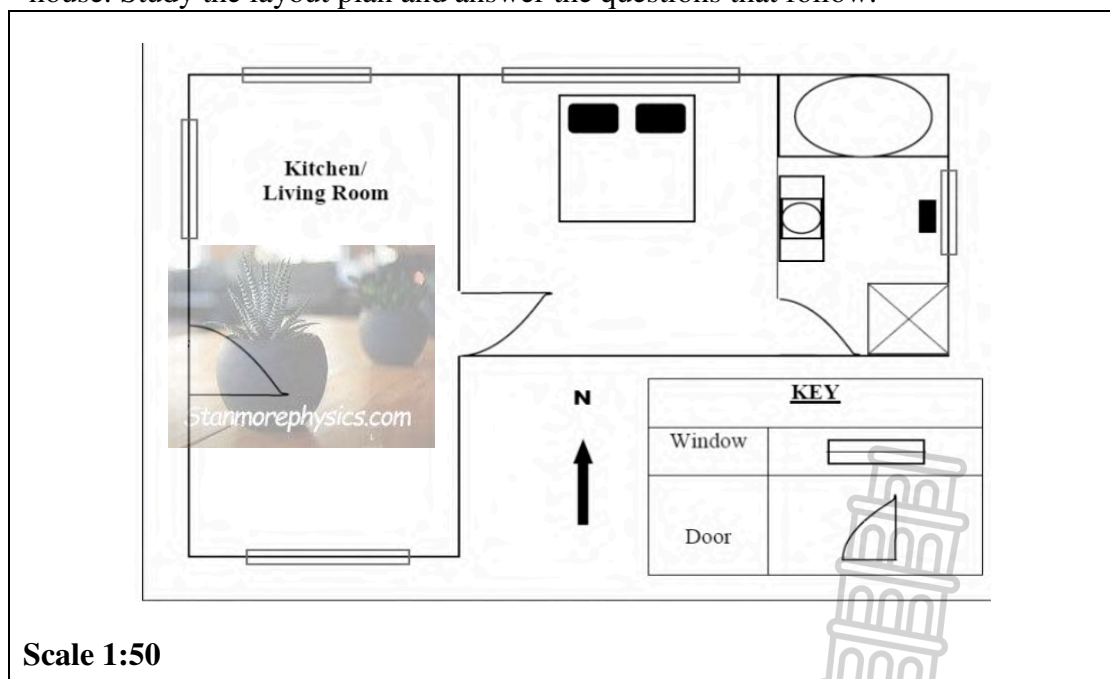

Use the information above to answer the questions that follow.

- 1.2.1 Determine the number of windows in the house. (2)
- 1.2.2 Explain the meaning of the given scale, **1:50**. (2)
- 1.2.3 The measured length of the kitchen is 4 m and the width is 3,5 m. Calculate the area of the kitchen (in m²). (2)



1.2.4 The surface area of the house to be painted measures 135 m^2 . The paint bought by Ms Tau has a spread cover rate of $7,5 \text{ m}^2$ per litre of paint. He intends applying TWO layers of paint.

Determine the minimum number of litres of paint he must buy.

(4)

[18]



QUESTION 2

2.1

Mr Mono is a general worker at Hyper Institute. He received the bank statement from his bank. The table below shows the part of the statement from 1 July 2024 to 26 July 2024.

PART OF MR MONO'S BANK STATEMENT FROM 1 JULY 2024 TO 26 JULY 2024

Date	Transaction	Debit	Credit	Balance
01/07/2024	Balance brought forward			R3 064,08
01/07/2024	Interest		R30,64	R3 094,72
06/07/2024	Cheque (save)		R2 400	R5 494,72
10/07/2024	POS Purchase	R444,27		R5 050,45
17/07/2024	Deposit (EFT)		A	R5 300,45
23/07/2024	Cash withdrawal	R680		B
26/07/2024	Closing balance			_____

***POS – point of sale e.g card purchase at till point**

Use the table above to answer the questions that follow.

2.1.1 Write the acronym EFT in full. (2)

2.1.2 Write the balance brought forward on 01/07/2024 in words. (2)

2.1.3 Determine the values of **A** and **B**, the deposit and the closing balance. (4)

2.1.4 Mr Mono withdrew R680 on 23/07/2024 from his own bank ATM and was charged R12,00 in banking fees for the transaction. He complained to the bank that he was incorrectly charged.

Verify with calculations if his statement is valid.

You may use the formula:

Banking fee = R3,00 + R1,20 per R100 (or part thereof). (4)

2.2 Mr Mono received a bonus of R20 000 from work and invested it in a fixed deposit account for 3 years at simple interest of 7,5% p.a.



2.2.1 Calculate the interest after 3 years in his fixed deposit account after three years. (3)

2.2.2 Calculate the total amount after the investment period. (2)

[17]



QUESTION 3

3.1

Mash and his friends went to the movies. The layout plan below shows the seating arrangement in the movie theatre.

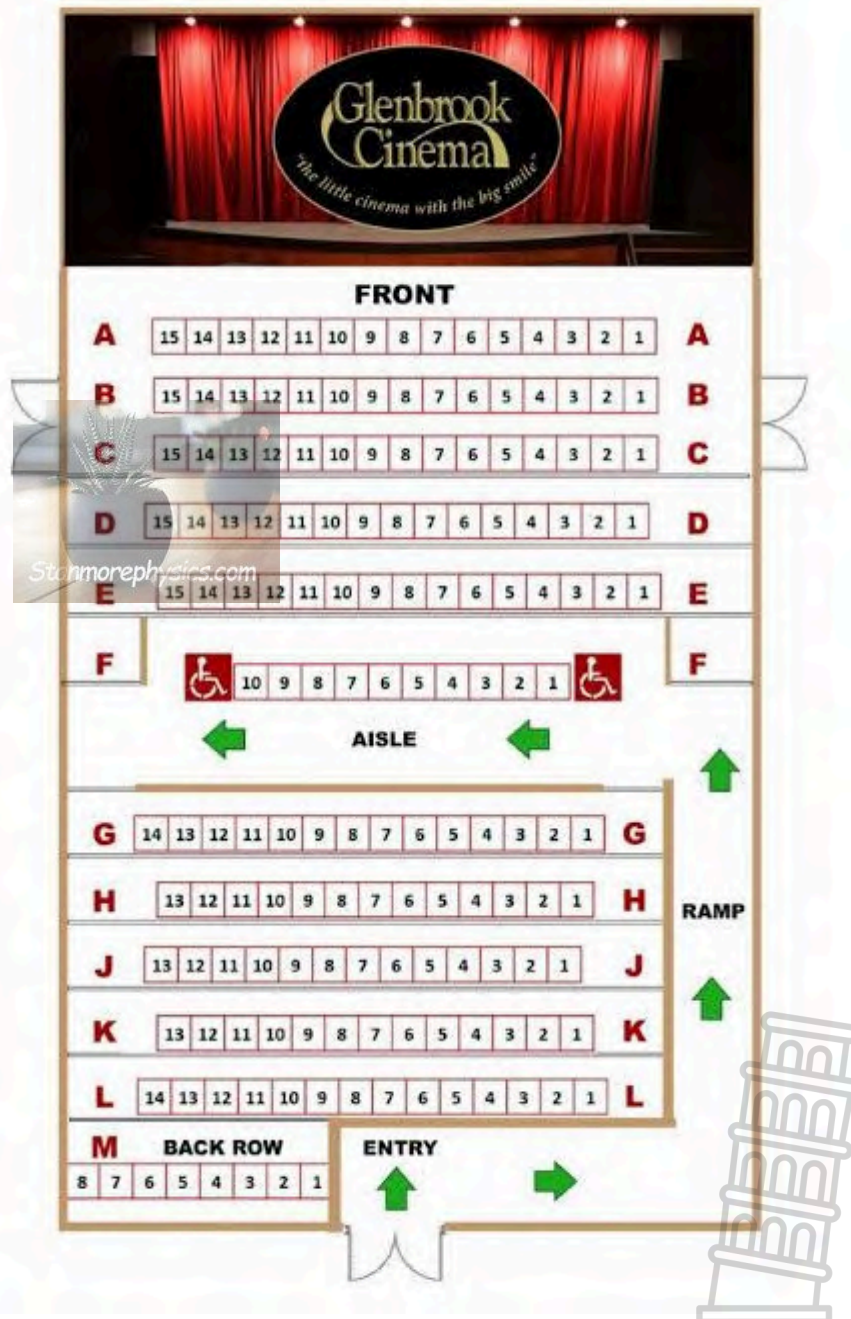

Adopted from <https://www.glenbrookcinema.com.au/general-info/seating-plan-and-photos>

Use the information above to answer the questions that follow.

3.1.1 Determine the total number of seats in the movie theatre. (3)

3.1.2 How many seats are allocated for wheelchairs? (2)

3.1.3 Write down the probability of selecting a person using a wheelchair in the movie theatre as a percentage. (4)

3.2

Mash and his friends buy a pizza for lunch after watching the movie. The base of the pizza has a diameter of 30 cm and a height of 12 mm.

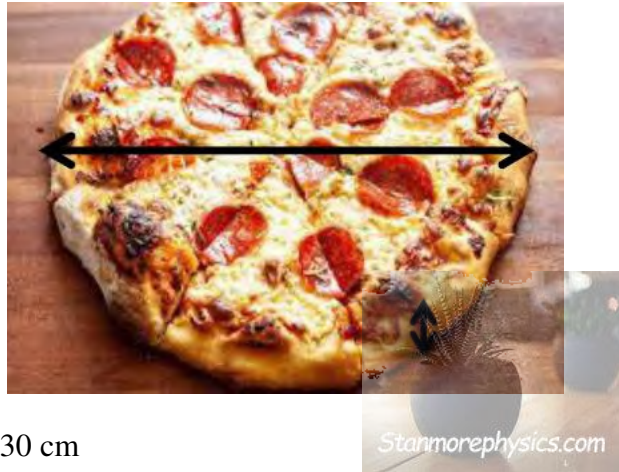

Diameter = 30 cm

Height = 12 mm

Adopted from Google

Use the information above to answer the questions that follow.

3.2.1 Determine the radius of the pizza base (in mm). (3)

3.2.2 Calculate the circumference of one pizza.

You may use the formula: Circumference = $2\pi r$, where $\pi = 3,142$ (3)

[15]

TOTAL: 50

