

SP: SOCIAL SCIENCE
GRADE 9
TERM 1: GEOGRAPHY TEST
MARCH 2025

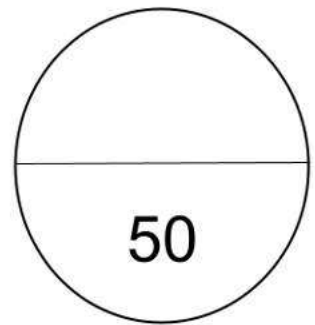

Learner Name: _____

Grade 9 _____

Question 1

Look at the contour map and answer the questions that follow.

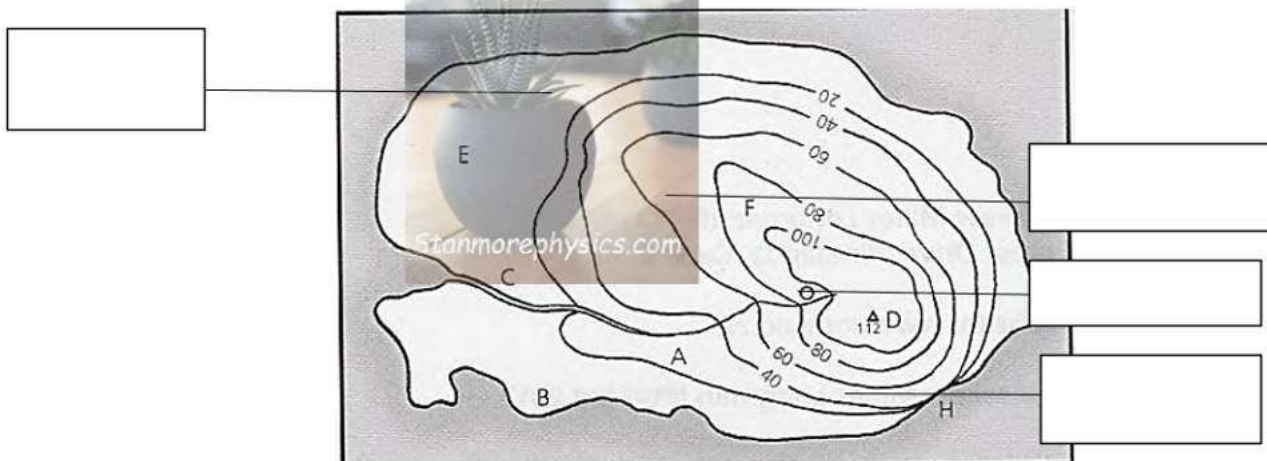

- a) Give the height of the contour line A (2)

- b) What are the contour intervals in the above diagram? (2)

- c) Match the letters on the map to the following natural features. (4)

Hilltop: _____

Cliff: _____

Spur: _____

River: _____

- d) Label the contour map above using the following labels (4)

steep slope	gentle slope	hill	ridge
-------------	--------------	------	-------

Question 2

a) What is a contour line?

(2)

Fill in the missing words

b) Steep slopes are indicated by contour lines that are _____ (1)

c) Gentle slopes are indicated by contour lines that are _____ (1)

d) You have two maps of your school showing exactly the same area of ground. One map is at the scale of 1:50m and the other is at the scale 1:10m. Which map would be the bigger one? (2)

Question 3: Label the following features

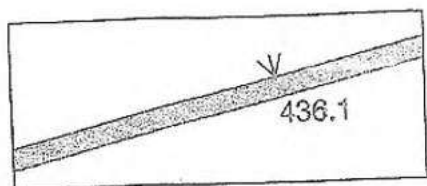

(2)

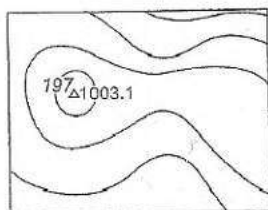

(2)

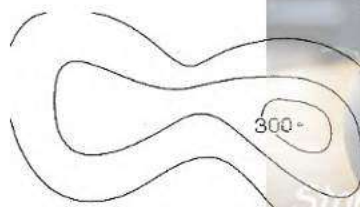

(2)

Use the map below to answer the questions that follow: **Contour patterns**

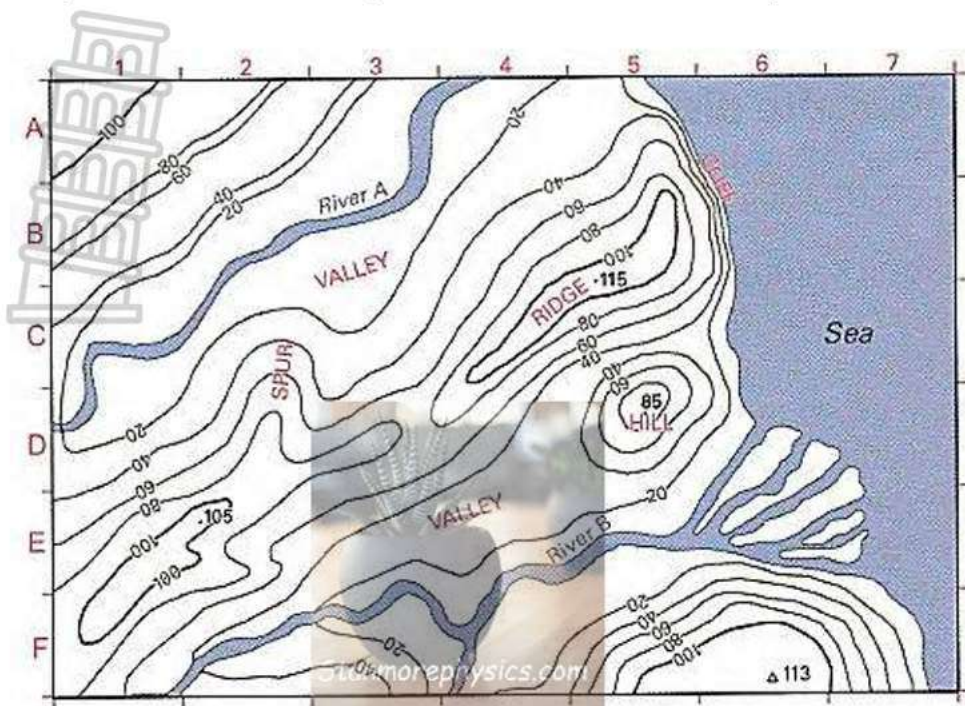

1. Name the landform features in grid square D5 _____ (2)
2. Write the O-rule that explains your answer to question 1.

3. The sausage-shaped contour lines crossing grid square C4 and C5 show a ridge. Name the grid squares where there is another ridge.

(2)

4. In which direction is river B flowing?

(2)

5. Write the V rule that explains your answer to question 4.

6. In which grid square is a landform, that would probably be called Table Hill?

Vertical aerial Photographs:



1. Write a sentence to describe what a vertical aerial photograph is:

(4)

2. How is a vertical aerial photograph used to draw a map of an area?

(3)

Total: (50)



Question 1

Look at the contour map and answer the questions that follow.

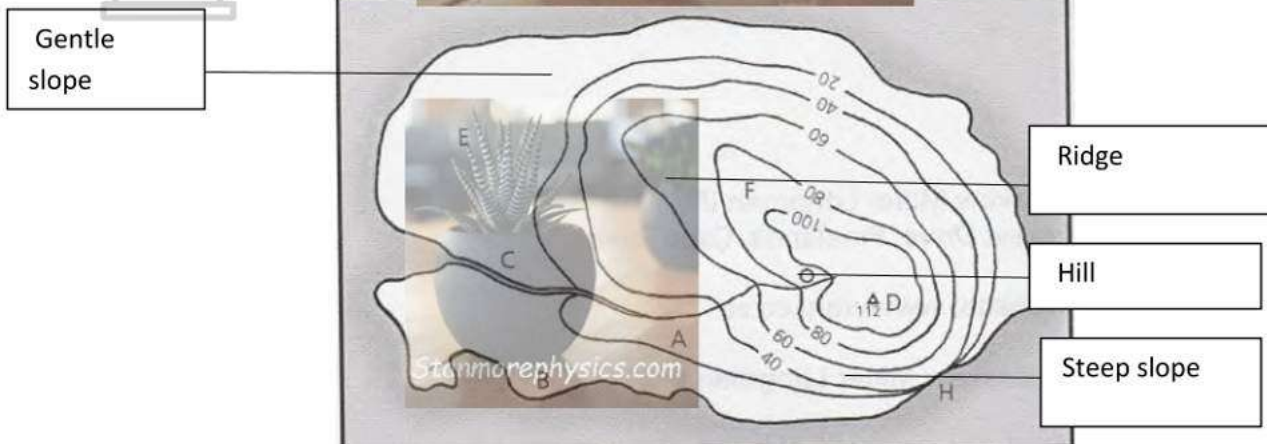

- a) Give the height of the contour line A **20m** (2)

- b) What are the contour intervals in the above diagram? **20m** (2)

- c) Match the letters on the map to the following natural features. (4)

Hilltop: **D**

Cliff: **H**

Spur: **F**

River: **C**

- d) Label the contour map above using the following labels (4)

steep slope

gentle slope

hill

ridge

- e) What is the height of the trig beacon? **112m** (2)

Question 2

Line that join places at the same height showing shape and slope.

Fill in the missing words

b) Steep slopes are indicated by contour lines that are **CLOSE TOGETHER** (1)

c) Gentle slopes are indicated by contour lines that are **FAR APART** (1)

d) You have two maps of your school showing exactly the same area of ground. One map is at the scale of 1:50m and the other is at the scale 1:10m. Which map would be the bigger one? (2)

1:10 m

Question 3: Label the following features

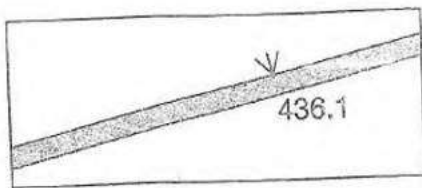

BENCHMARK (1)

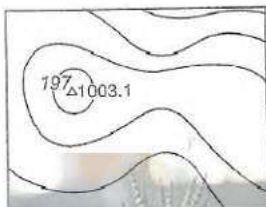

TRIG BEACON (1)



SPOT HEIGHT (1)

Question 4

Use the map below to answer the questions that follow: **Contour patterns**

