



LIMPOPO
PROVINCIAL GOVERNMENT
REPUBLIC OF SOUTH AFRICA

DEPARTMENT OF
EDUCATION

NATIONAL SENIOR CERTIFICATE

GRADE 10

MATHEMATICAL LITERACY P2

MID-YEAR EXAMINATION

JUNE 2025

MARKS: 50

TIME: 1 HOUR

This question paper consists of 7 pages including ANNEXURE.

INSTRUCTIONS AND INFORMATION

1. This question paper consists of FOUR questions.
2. Number answers correctly according to the numbering system used in this question paper.
3. Use ANNEXURE A to answer QUESTION 4.
4. An approved calculator (non-programmable and non-graphical) may be used.
5. All the final answers must be rounded off according to the context, unless stated otherwise.
6. Units of measurement must be indicated, where applicable



QUESTION 1

In **TABLE 1** below is a list of explanation and definitions of concepts used in Mathematical Literacy. Match the number with the correct letter of the definition or explanation.

Write down the letter next to the number. Example **1.6 J**

Collum	Definition/explanation
1.1 Thermometer	A. The use of cardinal directions (i.e. North, South, East and West) to describe the location of one point to the other
1.2 Tape measure	B. The rate of covering a certain distance over time.
1.3 Maps Scale	C. A measure of body fat based on the height and weight of a person.
1.4 Compass direction	D. An instrument used to measure temperature.
1.5 Tree diagram	E. A special type of a diagram used to determine the outcomes of an event in a probability example
	F. The arrangement of something laid out such as structural features of a mall
	G. The ratio of the distance in real life compared to the same distance on a map.
	H. A flexible ruler used to measure the length, width, or height.

2 x 5 = /10/

QUESTION 2

Mukundi is a grade 10 learner at Rabuntu High school in 2019. She developed a calendar with different activities that she would be engaged on. Below is her May 2019 activity calendar

Mukundi May 2019 Activity Calendar

			W	TH	F	S
			1 Holiday	2 Baby Day	3 Lumpy Rug Day	4 Star Wars Day
S	M	T				
5 National Noodle Day	6 Beverage Day	7 Tourism Month	8 Iris Day	9 Lost Sock Memorial Day	10 Clean Up Your Room Day	11 Wildflower Week
12 International Nurse's Day	13 Leprechaun Day	14 Dance like a Chicken Day	15 Chocolate Chip Cookie Day	16 Lucky Penny Day	17 Pack Rat Day	18 No Dirty Dishes Day
19 Bike Week	20 Pick Strawberries Day	21 National Waiter and Waitress Day	22 EMS TEST	23 Lucky Penny Day	24 Escargot Day	25 Tap Dance Day
26 Hamburger Month	27 Sunscreen Day	28 Photography Month	29 BBQ and Salad Month	30 Water a Flower Day	31 Macaroon Day	

Source: <https://www.dreamstime.com>

Use the information above to answer questions that follows.

- 2.1 Write down the date on which Mukundi enjoyed beverage (2)
- 2.2 Mukundi needs 10 hours to prepare for EMS test. She decides to study for 2 hours per day. Determine the day Mukundi should start preparing for her EMS test. (2)
- 2.3 Give a reason Mukundi would not go to school on the first day of May 2019. (2)
- 2.4 Mukundi wants to travel from Polokwane to Pretoria to see her mother during holiday.
 - 2.4.1 Estimate the distance for the single trip from the options listed below (2)
 - A. 2670 m
 - B. 26700 cm
 - C. 267 km.
 - 2.4.2 Mukundi was using a public transport to her trip to Pretoria. She said that by 16H00 he should be in Pretoria. The taxi driver was driving 120km per hour and they stopped at the garage for 30 minutes. They left Polokwane at 13H30.

Use your answer above to verify weather her statement is correct. You may use the formula: **speed = distance ÷ time** (4)

/12/

QUESTION 3

Errol need to buy a trouser at a clothing shop. He decided to go to the nearest mall, Madonsi Mall. ANNEXURE A shows a floor plan of Madonsi Mall.

Use the information above and ANNEXURE A to answer the following questions.

- 3.1. Determine the number of clothing shops found at Madonsi mall. (2)
- 3.2. Determine is the general direction of Woolworths from Shoprite Checkers. (2)
- 3.3. List THREE shops that are found at the southeastern part of Edgars. (3)
- 3.4. Explain the meaning of the scale 1:1000 (2)
- 3.5. Use a ruler to measure the length of a mall and calculate the actual length in metres. (4)
- 3.6. Give a reason it is necessary to have parking area in every mall. (2)

/15/

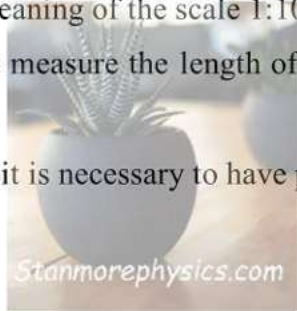

QUESTION 4

Millicent plans to bake a vanilla sponge cake for her aunt's birthday. She saw a recipe for her choice cake. The cake can serve a 14 people.

Below are the ingredients used to bake.

Ingredients of a birthday cake

- 4 large eggs
- 3/4 cup of sugar (175g)
- 1 cup all-purpose flour (120g)
- 1/4 teaspoon salt
- 1 teaspoon baking powder
- 1 teaspoon of vanilla extract
- 3 tablespoons of milk
- 1/3 cup of melted butter.



NB: 1 teaspoon = 15ml

1 cup = 250ml

Preheat the oven to 302 °F

<https://www.yummytummyvaarhi.com>

Use the information above to answer the questions that follow.

- 4.1 Determine the number of ingredients required for this recipe. (2)
- 4.2 Calculate the number of millilitres of milk needed. (2)
- 4.3 Calculate the number of kilograms (rounded to one decimal) of all-purpose flour that can be used in the recipe to serve 56 people. (4)
- 4.4 Give a reason it is important to measure the ingredients accurately while baking. (2)
- 4.5 Millicent uses the oven with °C.
Convert the temperature to degree Celsius (°C)
You may use the formula $^{\circ}\text{C} = (^{\circ}\text{F} - 32) \div 1,8$. (3)

/13/

TOTAL = [50]

ANNEXURE A

QUESTION 3

FLOOR PLAN OF MADONSI MALL

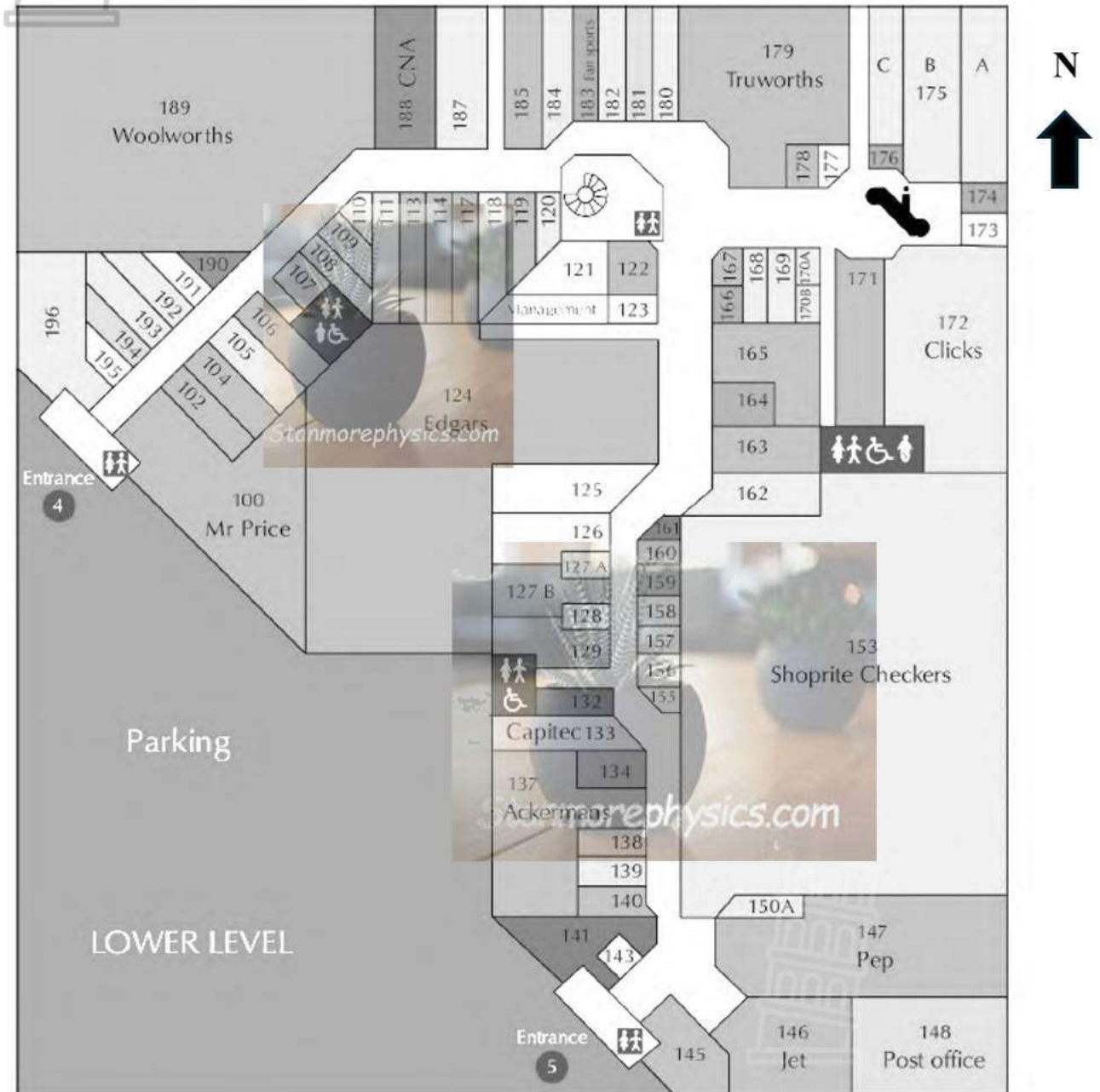

Scale 1:1000

Adapted from www.siyavula.com



LIMPOPO
PROVINCIAL GOVERNMENT
REPUBLIC OF SOUTH AFRICA

DEPARTMENT OF
EDUCATION

NATIONAL SENIOR CERTIFICATE

GRADE 10

MATHEMATICAL LITERACY P2

MID YEAR MEMORANDUM

JUNE 2025

MARKS: 50

Symbol	Explanation
MA	Method with accuracy
CA	Consistent accuracy
A	Accuracy
C	Conversion
S	Simplification
RT	Reading from the table
SF	Correct substitution
R	Rounding
NPR	No penalty for rounding
NPU	No penalty for omitting correct unit
AO	Answer only
MCA	Method with constant accuracy

This marking guideline consists of 3 pages including the cover page.

Question	Solution	Explanation
QUESTION 1 [10 Marks]		
1.1.1	D ✓✓	2A Correct options
1.1.2	B ✓✓	2A Correct options
1.1.3	G ✓✓	2A Correct options
1.1.4	A ✓✓	2A Correct options
1.1.5	E ✓✓	2A Correct options
		[14]
QUESTION 2 [12 Marks]		
2.1	6 May 2019 ✓✓	2A, Correct Date
2.2	Pack Rat Day ✓✓	2A, Correct answer
2.3	It is a holiday ✓✓	2A, Reading from the calendar
2.4.1	C ✓✓	2A Correct answer
2.4.2	$120\text{km} = 1\text{h}$ $267\text{ km} = x$ Time = $267\text{km} \div 120\text{km}$ $= 2,225\text{hrs}$ $= 2\text{hrs and } 0,225 \times 60$ $= 2\text{hrs } 14\text{minutes} + 30 \text{ (stopping time)}$ $= 2\text{hrs } 44 \text{ minutes}$ Arrival time = $13:30 + 2\text{hrs } 45\text{minutes}$ $= 16:14$ The statement is incorrect. ✓	1M for division 1C for conversion 1M for addition 10 for the opinion
		[12]
QUESTION 3 [15 Marks]		
3.1	7 ✓✓	2RT Reading from the map
3.2	North West ✓✓	2A Correct directions
3.3	Shoprite Checkers ✓ Pep ✓ Jet ✓	3A Correct answers
3.4	1 unit represent 1000 unit on the actual ground ✓✓	2O Explanation
3.5	Measured length = 16.9 cm ✓ Actual length = 16.9×1000 $= 16\ 900 \div 100$ $= 169 \text{ m}$ ✓	1A Correct measurement (Allow 16.7 cm – 17.1 cm) 1M Multiplication by 1000 1 Dividing by 100 1 Correct answer
3.6	Convenience for shoppers ✓✓ OR	2O Reasoning

